

Welcome to



RIDGE HILL

Property Overview **2**

Area Highlights **8**

Our Customer **12**

The Plan for Ridge Hill **15**



A photograph of three people at an outdoor beer festival. On the left, a woman with glasses and a black top smiles while holding a beer. In the center, a man in a blue denim jacket and cap smiles, holding a beer with a 'RIDGE HILL' logo. On the right, a woman in a green top looks towards the others, also holding a beer. The background is filled with festival banners and structures.

PROPERTY

OVERVIEW

Look Up

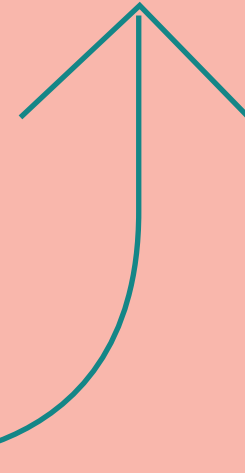

Property Overview



There's plenty to see at Ridge Hill. This is the place to gather with your community and find your flavor.

We act as a modern town square, where all can have a connective and social experience. Tackle your to-do list, discover a new weekend attraction, and take your pup to the dog park, all in one vibrant hilltop location.



Change is Coming



And it's the really, really cool kind.

Explore over 1M SF of retail, only 18 miles from Manhattan. Jog along open green space, knock out some work at a local café, or meet up with friends to try a new restaurant. This is Ridge Hill, Westchester's hub for just about... everything.

PARK PLAZA

Center your brand for connection



SPRAIN BROOK PKWY

LOWER LEVEL

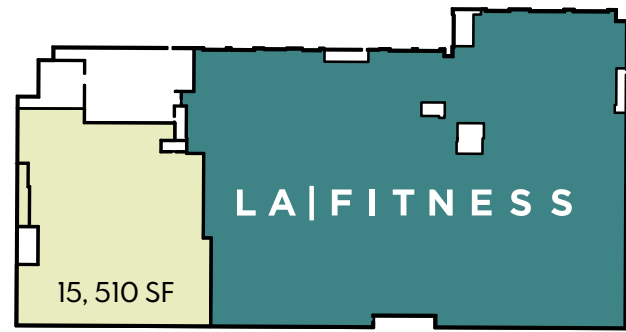

LEASING LEGEND

- LEASED
- LEASED/ NOT OPEN
- LEASE NEGOTIATION
- LOI
- AVAILABLE

GROUND LEVEL

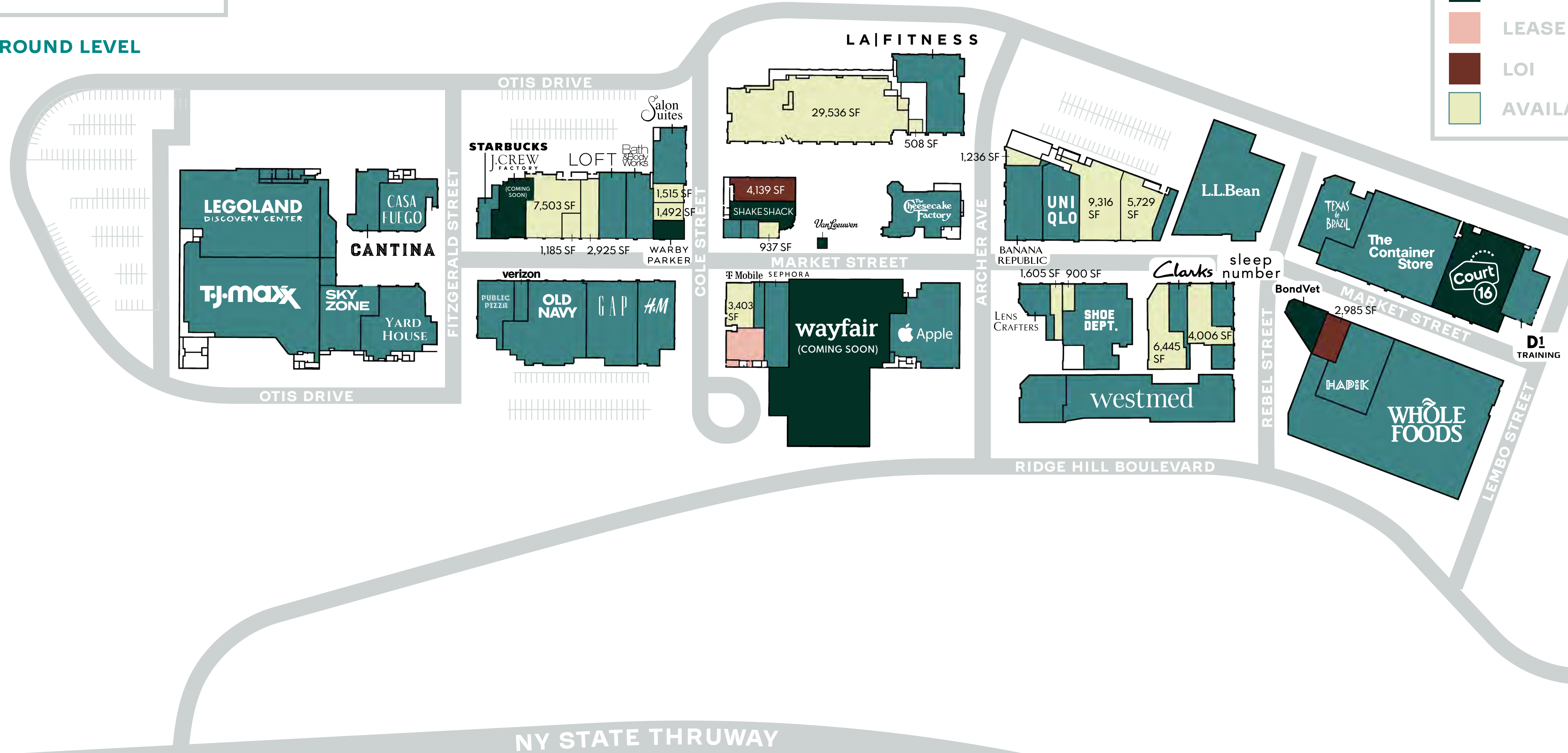

Site Map

NY STATE THRUWAY

SPRAIN BROOK PKWY

LEASING LEGEND

- LEASED
- LEASED/ NOT OPEN
- LEASE NEGOTIATION
- LOI
- AVAILABLE

LEVEL 2

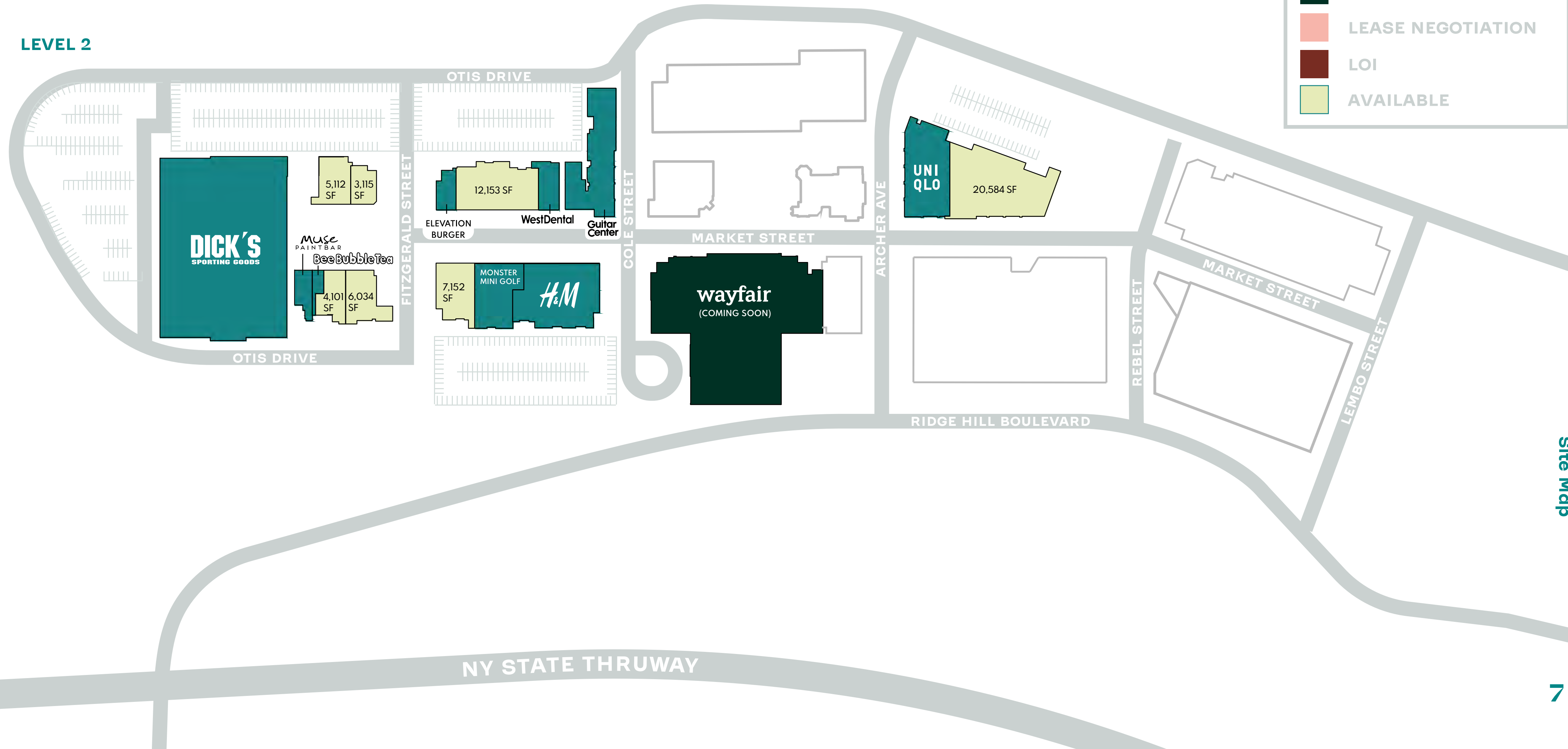

Site Map

NY STATE THRUWAY



AREA

HIGHLIGHTS



This must be the spot



Only 18 miles from Manhattan and accessible via the New York State Thruway, Ridge Hill holds space in the coveted Westchester County. Visitors can easily stop by these 84 acres of multi-use space from the Bronx and other key locales.



Centered in Westchester

Area Highlights



Ridge Hill's unique opportunity in Westchester County, New York, provides a captivating blend of suburban charm, picturesque landscapes, affluent communities, and proximity to the bustling metropolis of NYC. Here, urban convenience and tranquil living converge.



Near diverse neighborhoods, including tree-lined Scarsdale, boutique-filled Rye, and historic Sleepy Hollow and Tarrytown

Surrounded by elegant estates, colonial-style homes, and modern condominiums, meeting a wide spectrum of preferences

County filled with museums, galleries, and performance venues, including the Neuberger Museum of Art, Caramoor Center for Music and the Arts, and Jacob Burns Film Center

Outdoor recreation includes hiking and biking along the scenic trails of the Rockefeller State Park Preserve and the Untermyer Gardens

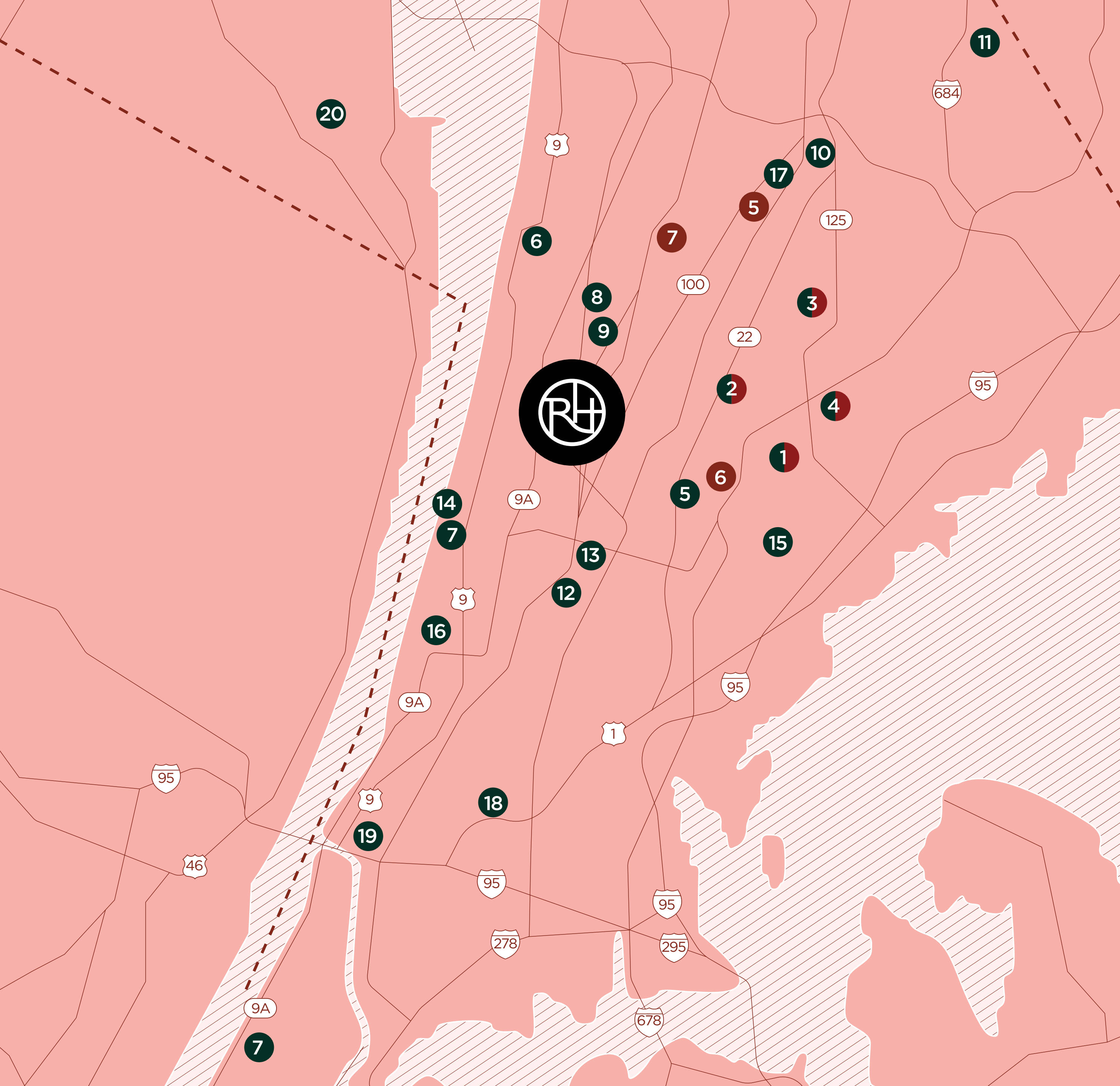

- POINT OF INTERESTS**
- 1 New Rochelle
 - 2 Eastchester
 - 3 Scarsdale
 - 4 Winged Foot/Quaker Ridge
 - 5 Bronxville
 - 6 Dobbs Ferry
 - 7 Central Park
 - 8 St Andrews Golf Club
 - 9 Sprain Ridge Park/Mountain Biking
 - 10 Downtown White Plains
 - 11 White Plains
 - 12 Empire City Casino
 - 13 Cross County Mall
 - 14 Yonkers Riverfront/Housing
 - 15 Iona University
 - 16 University of Mount Saint Vincent
 - 17 Empire State University at Hartsdale
 - 18 Fordham University
 - 19 Yeshiva University
 - 20 Dominican University
- COUNTRY CLUBS**
- 1 Wykagyl Country Clubs
 - 2 Lake Isle Country Clubs
 - 3 Fenway Country Clubs
 - 4 Bonnie Briar Country Clubs
 - 5 Scarsdale Country Clubs
 - 6 Siwanoy Country Clubs
 - 7 Sunningdale Country Clubs

18 miles
FROM MANHATTAN

75,000
VEHICLES PER DAY
STATE THRUWAY (I-87) ACCESS

7.25 miles
TO THE MARIO CUOMO BRIDGE

9.1 miles
TO THE GEORGE WASHINGTON BRIDGE

Ridge Hill Blvd
BUS LINE ACCESS

25-minute
TRAIN TO GRAND CENTRAL STATION

6 universities
WITHIN 10 MILES



Area Map

RidgeHill.com

RIDGE HILL
WESTCHESTER
COUNTY

For leasing inquiries, please contact:

Morgan Liesenfelt
morgan.liesenfelt@ridgehill.com

Matthew Krell
Lucas Kooyman
Max Swerdloff
RHleasing@ampsre.com

「AM
PS」